

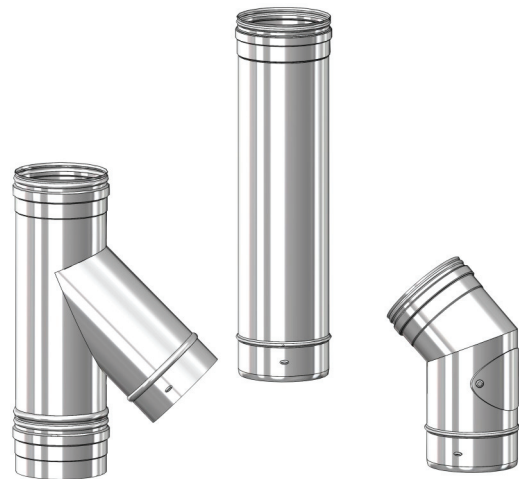

SYSTEM 39

Single Wall 304
Grade Stainless Steel
Connecting and
Relining Flue Pipe

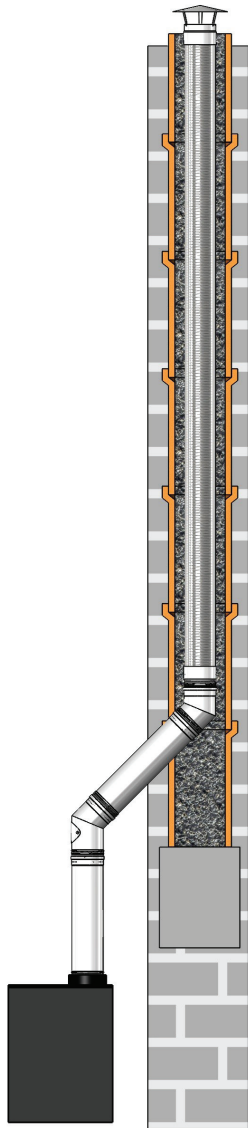

C € 0120



Mi-Flues System 39 Single Wall Stainless Steel Chimney

INTRODUCTION

Mi-Flues System 39 is a factory made single wall flue system comprising of a range of lengths, tees, bends and associated fittings and supports.

System 39 is available in five standard diameters: 100mm, 125mm, 150mm, 180mm and 200mm.

PRODUCT DESCRIPTION

All lengths and flue gas carrying fittings are made from 304-grade stainless steel. This is a high quality annealed austenitic stainless steel.

The pipe seams are continuously seam welded which provides an excellent gas sealed joint and offers minimum resistance to flue gas flow.

APPROVALS

Mi-Flues System 39 is manufactured and conforms to :

EN1856-2 T300 N1 D Vm L20040 O(**)

Note : **3 times diameter of the flue

Mi-Flues System 39 is designated suitable for a connecting flue pipe and rigid chimney liner.

APPLICATION

System 39 is suitable for the following applications :

- * Flue gas system for gas and oil fired appliances, as recommended by the appliance manufacturer
- * For relining existing chimneys using oil and gas fired appliances
- * Ventilation—boiler rooms, laundries and kitchens
- * Fume extraction

It has been designed for flue gas temperatures not exceeding 300°C.

It is not suitable for condensing applications.

COMPONENTS

Mi-Flues System 39 has been designed to be installed quickly, safely and simply.

The system comprises of plain lengths, adjustable lengths, bends, bends with inspection/cleaning access, tees complete with cleaning inspection caps, cowls and support brackets.

JOINTING SYSTEM

Components are joined together by fitting the male end of the first section into the female end of the second section (as shown opposite).

Mi-Flues System 39 has a unique press fit jointing system, which provides structural stability.

This jointing system ensures a quick and easy installation offering excellent gas tightness properties.

System 39 has a unique **clik clak** system which does not require the use of a locking band.

INSTALLATION

1. Select the components required for installation.
2. Ensure the male end of the liner chimney system always points downwards in the direction of the heating appliance.
3. Align the locating dimple and twist-lock dimple on the male end of the chimney liner system with the locating dimple and receiver on the female end of the chimney system as shown below.
4. Firmly push both chimney sections together ensuring to keep locating dimple system in complete alignment .
5. Hold lower chimney section and gently twist uppermost section to achieve desired twist lock system
6. Seal using Mi-Flues high temperature sealant (rated to 1000°C) or a suitable fire cement. See illustration below

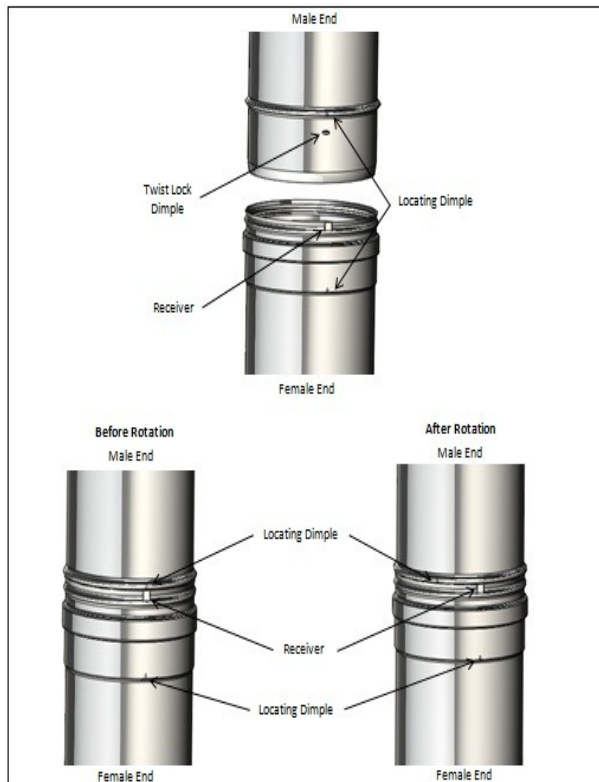

Installation must be in accordance with Building Regulations Document J.

System 39 operates most efficiently where there is a vertical run from the appliance to the terminal. A selection of bends are available to provide an offset from the vertical. The chimney should not make an angle more than 45° with the vertical, except where the flue is connected to the back outlet of the appliance. To prevent excess condensation of the flue gases and potential freezing, System 39 is not permitted for external runs.

Mi-Flues System 39 Single Wall Stainless Steel Chimney

LENGTHS

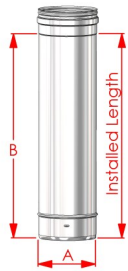

Lengths are available in 250mm, 500mm, 1000mm and 1250mm.

(A) Dia	(B)250	(B)500	(B)1000	(B)1250
100	196	446	946	1196
125	196	446	946	1196
150	196	446	946	1196
180	196	446	946	-
200	196	446	946	-

ADJUSTABLE LENGTH

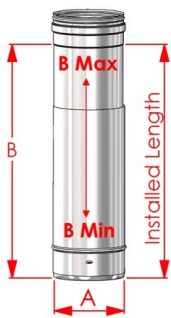

Adjustable lengths are available to assist achieving the exact length required where a standard length is not suitable. Adjust the pipe to the required length and secure directly above the overlap joint using a support bracket. The joint is sealed using Mi-Flues high temperature sealant (rated to 1000°C) or a suitable fire cement. Caution must be taken that the overlap between the two pipes must never be less than 80mm.

Product	Diameter (A)	ADJ Short (B) Min -Max
Sys.39	100	340-490
Sys.39	125	340-490
Sys.39	150	340-490
Sys.39	180	340-490
Sys.39	200	340-490

45° BEND

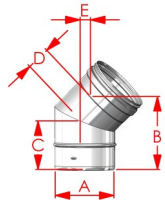

Used to provide a 45° change of direction or can be used in pairs to create an offset. Two by 45° bends can be used to create a 90° bend.

Product	(A)	(B)	(C)	(D)	(E)
Sys.39	100	130	100	50	35
Sys.39	125	138	105	57	42
Sys.39	150	142	109	60	43
Sys.39	180	155	115	67	45
Sys.39	200	162	115	75	54

45° BENDS WITH DOOR

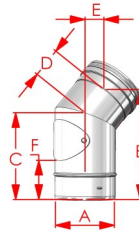

Used to provide a 45° change of direction or can be used in pairs to create an offset. The inspection door provides access for cleaning.

DIA(A)	(B)	(C)	(D)	(E)	(F)
100	173	135	52	35	35
125	195	163	55	35	69
150	195	165	61	35	70
180	242	185	67	48	99
200	250	200	70	50	120

90° BEND

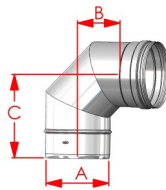

Used to provide a 90° change in direction. It can be taken to be equal to 2 x 45° bends.

Product	Dia. (A)	(B)	(C)
Sys.39	100	94	150
Sys.39	125	110	150
Sys.39	150	115	165
Sys.39	180	140	190
Sys.39	200	148	205

90° BENDS WITH DOOR

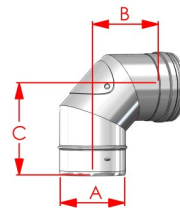

Used to provide a 90° change in direction. The inspection door provides access for cleaning. It can be taken to be equal to 2 x 45° bends.

Product	Dia. (A)	(B)	(C)
Sys.39	100	94	150
Sys.39	125	110	150
Sys.39	150	115	165
Sys.39	180	140	190
Sys.39	200	148	205

Mi-Flues System 39 Single Wall Stainless Steel Chimney

45° TEE

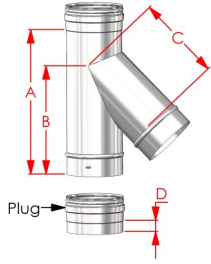

Used to provide a 45° change of direction. Also used as an inspection/cleaning component.

Product	Dia.	(A)	(B)	(C)	(D)
Sys.39	100	255	206	160	25
Sys.39	125	275	220	200	25
Sys.39	150	336	270	220	25
Sys.39	180	366	298	257	25
Sys.39	200	420	335	290	25

90° TEE

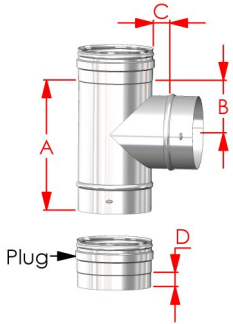

Used to provide a 90° change of direction. Also used as an inspection/cleaning component.

Product	Dia.	(A)	(B)	(C)	(D)
Sys.39	100	255	100	30	25
Sys.39	125	255	100	30	25
Sys.39	150	255	100	30	25
Sys.39	180	280	112	30	25
Sys.39	200	305	125	30	25

ADAPTORS—START OFF

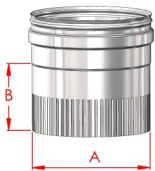

The System 39 start off adaptor can only be used on oil and gas appliances where recommended by the appliance manufacturer. (The table below gives the nominal diameter prior to crimping).

Dia. (A)	(B)
100	76
125	76
150	76
180	76
200	76

ADAPTOR—REDUCING (Tapered)



The System 39 reducing adaptor can only be used on oil and gas appliances where recommended by the appliance manufacturer.

Product	(A)	(B)	(C)
Sys.39	100	80	130
Sys.39	125	100	130
Sys.39	150	125	130
Sys.39	180	150	130
Sys.39	200	180	130

CHIMNEY TERMINATION—COWLS

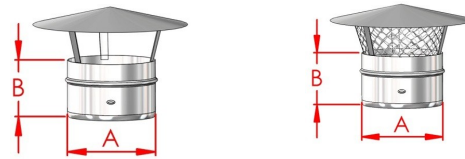

A cowl is the top rain cap for a chimney. Its purpose is to stop the infiltration of rain or snow to the inside of the chimney. For oil fired appliances a stainless steel cowl is attached to the end of the flue pipe (cowls with bird guards are not available for oil appliances). For gas appliances a cowl with mesh should be used.

Product	(A)	(B)
Sys.39	100	85
Sys.39	125	85
Sys.39	150	85
Sys.39	180	85
Sys.39	200	85

STORM COWL

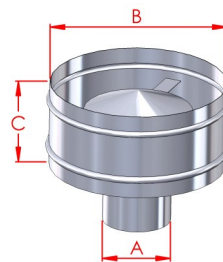

The Storm Cowl offers the greatest protection against rain and adverse weather conditions. It reduces the possibility of wind affecting the appliance. It can be used on oil fired appliances. It should be secured in position with the use of stainless steel self tappers or rivets (not provided by Mi-Flues)

Product	(A)	(B)	(C)
Sys.39	100	272	155
Sys.39	125	295	155
Sys.39	150	320	155
Sys.39	180	347	155
Sys.39	200	370	155

Mi-Flues System 39 Single Wall Stainless Steel Chimney

H COWL

A H Cowl is used to reduce the possibility of down draught problems occurring. The H Cowl slides telescopically inside the previous length. It can be used on oil fired appliances. It can be secured in position with the use of stainless steel self tappers or rivets (not provided by Mi-Flues)

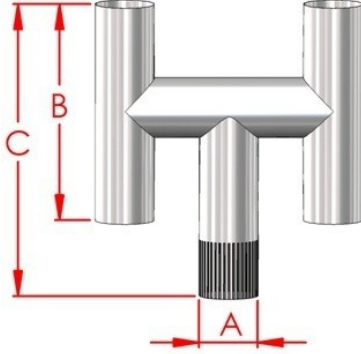

Product	(A)	(B)	(C)
Sys.39	100	350	592
Sys.39	125	457	751
Sys.39	150	457	751
Sys.39	180	490	795
Sys.39	200	560	900

ANTI DOWNDRAUGHT COWL

An Anti Downdraught cowl is used to reduce the possibility of a down draught problem. It slides telescopically inside the previous length. It can be secured in position with the use of stainless steel self tappers or rivets (not provided by Mi-Flues)

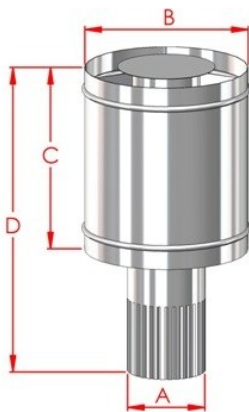

Product	(A)	(B)	(C)	(D)
Sys.39	100	205	250	529
Sys.39	125	230	250	545
Sys.39	150	276	305	564
Sys.39	180	322	356	764
Sys.39	200	369	405	919

WALL BRACKET

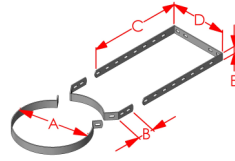

A Wall Bracket provides lateral support. It should be used at 1.5mtr intervals. This component is adjustable between 60mm and 250mm off a wall face.

Product	(A)	(B)	(C)	(D)	(E)
Sys.39	125	45	258	152	20
Sys.39	150	45	258	152	20
Sys.39	180	45	258	152	20
Sys.39	200	45	258	152	20

ECONOMY WALL BRACKET

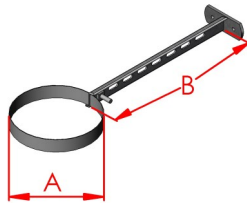

The Economy Wall Bracket provides lateral support. The T piece is fixed to the wall with fittings adequate for the purpose. The wrap around section is clamped around the flue section and fastened to the T Piece with the nut and bolt supplied.

Dia. (A)	(B)
100	250
125	250
150	250

OFFSET CHART

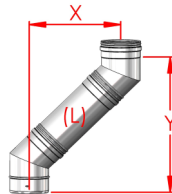

This offset chart uses the recommended Mi-Flues System 39 45° bends. Within a run of system 39 flue no more than two offsets should be used. Two bends are used to create one offset.

System 39 Offset Chart						
(L)	Offset	100mm	125mm	150mm	180mm	200mm
0	X	108	117	125	132	128
	Y	258	280	294	320	312
250	X	249	260	265	275	267
	Y	395	425	435	464	450
500	X	425	437	440	450	455
	Y	572	600	612	640	655
1000	X	779	790	792	800	797
	Y	928	955	965	990	983
1250	X	956	961	970	-	-
	Y	1102	1119	1138	-	-
Adjustable Length						
	X Min	312	357	365	370	379
	X Max	418	463	470	472	484
	Y Min	459	512	538	565	575
	Y Max	565	615	644	669	680

Mi-Flues System 39 Single Wall Stainless Steel Chimney

SAFETY /INSTALLATION/REGULATION

Distance to Combustible materials

Mi-Flues System 39 should be fitted at least three times the diameter of the pipe away from any combustible materials.

Cleaning / Maintenance

Adequate provision should be made for inspecting and cleaning the chimney system. Lengths and bends are available with access doors in the product range. A 90° Tee is also available as an Inspection/ Cleaning component. Cleaning/Inspection access should be provided to suit the installation, unless sweeping can be undertaken through the appliance. The chimney should be inspected regularly and cleaned at least twice a year, depending on usage and type of fuel used. This should be carried out with the use of a brush which should not be made from black steel.

The chimney should be maintained to ensure that the construction remains in good condition.

Any components showing signs of deterioration which may affect performance should be replaced under professional advice, any evidence of leakage identified by smoke staining should be rectified immediately.

Please ensure that labels are removed from product prior to installation and relevant information transferred to chimney plate.

Chimney Plate

The chimney plate provides information regarding the Manufacturer, designation, nominal size, distance to combustibles, Installer name, installation date, chimney location and thermal distance.

It is to be completed by the Installer and securely fixed in an unobtrusive but obvious position within the building such as next to the electricity or gas consumer unit, next to the chimney or hearth or next to the water supply stop cock.

Handling and Storage

All System 39 components are individually labelled. They should be stored in a dry suitable storage location. The product is easy to handle, but care should be taken when holding, fitting or assembling any part of the system.

Users are advised to use suitable precautions such as gloves etc to avoid injury.

Life Expectancy

Under normal operating conditions, and providing the system is installed and maintained correctly, Mi-Flues System 39 should provide many years service and is provided with a 10 year conditional life expectancy.

SYSTEM 39 CONNECTION TO EXISTING CHIMNEY

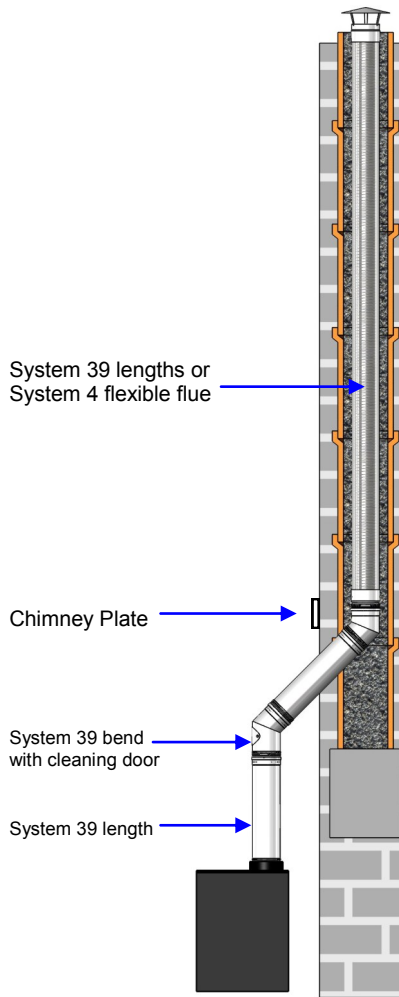

Technical Data							
Fuel	Oil and Gas						
Material	304 Stainless Steel						
PRODUCT DESIGNATION							
System 39	EN1856-2	T300	N1	D	Vm	L20040	O(**)
System 39	EN1856-2	T300	N1	D	Vm	L20040	O
Standard	↑	↑	↑	↑	↑	↑	↑
Temperature Level	↑	↑	↑	↑	↑	↑	↑
Pressure Level	↑	↑	↑	↑	↑	↑	↑
N, P or H	↑	↑	↑	↑	↑	↑	↑
Condensate Resistance	↑	↑	↑	↑	↑	↑	↑
W:Wet or D:Dry	↑	↑	↑	↑	↑	↑	↑
Corrosion Resistance (durability against corrosion)	↑	↑	↑	↑	↑	↑	↑
Material specification	↑	↑	↑	↑	↑	↑	↑
Sootfire resistance and distance to combustibles	↑	↑	↑	↑	↑	↑	↑
G:Yes or O:No / distance to combustibles in mm	↑	↑	↑	↑	↑	↑	↑
NM (Not Measured) or M (Measured)	↑	↑	↑	↑	↑	↑	↑

Note: **3xdiameter of the flue

All flue systems must be installed according to current Building Regulations. Mi-Flues has adopted a policy of continuous product review, and in the interests of development and improvement the Company reserves the right to vary the appearance and performance of any of its products without prior notice. Correct at time of print. For updates please check our website.